

REV.	ECN NO. / DESCRIPTION	DATE

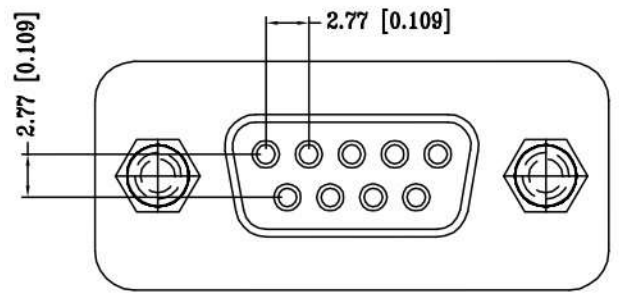
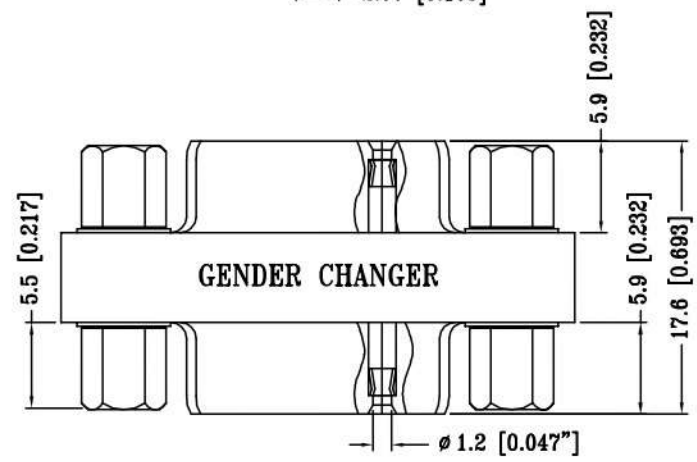
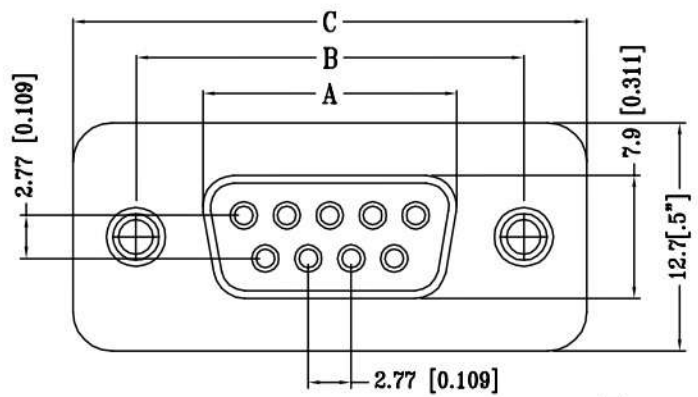

MATERIAL

INSULATOR: BLUE PBT UL94 V-0 RATED
 CONTACTS: BRASS
 SHELL: STEEL

FINISH

CONTACTS: GOLD FLASH OVER NICKEL
 SHELL: NICKEL PLATED

ELECTRICAL CHARACTERISTICS

CONTACT RESISTANCE: 25m Ω MAX
 CURRENT RATING: 5 AMPERES
 INSULATION RESISTANCE: 5000M Ω MIN
 DIELECTRIC WITHSTANDING VOLTAGE: 1000VAC 60SEC

PART NO.	Circuits	A	B	C
12.03.2030	9	16.3(.642")	25.0(.984")	31.2(1.22")

GENERAL TOLERANCES UNLESS SPECIFIED		PART NO.	SECOMP
.X \pm 0.30	X. $^{\circ}$ \pm 3 $^{\circ}$	12.03.2030	
.XX \pm 0.15	X. $^{\circ}$ \pm 1.5 $^{\circ}$	APPROVE	TITLE
.XXX \pm	.XX $^{\circ}$ \pm	Ted Ju 07/02 '04	ROLINE Mini Gender Changer, 9-pin F-F
CUSTOMER DRAWING		CHECK	DWG NO.
		Ted Ju 07/02 '04	LAP-A2215CB2L
SIZE	UNITS	DRAW	SHEET
A4	MM[INCH]	C.C.S 07/02 '04	1 / 1
			SCALE
			1:1
			REV
			1

